

Dual-Monitor Arm 180 Degrees

vari®

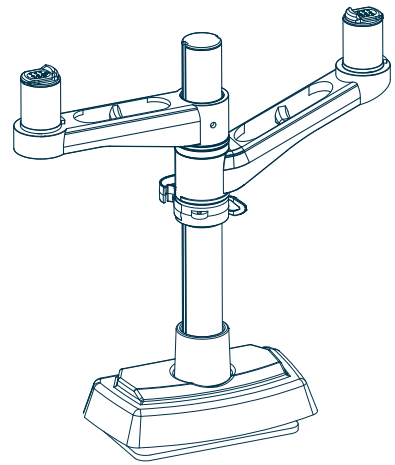

BASE & POST
x1



MONITOR BRACKET
x2

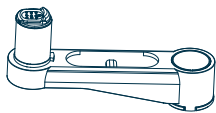

SWIVEL ARM
x2

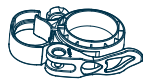

POST COLLAR &
QUICK RELEASE CABLE MANAGER
x1

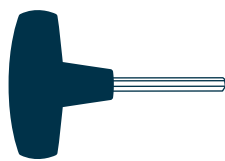

M1 HANDLED ALLEN WRENCH
x1



MONITOR SCREWS
x8



M3 SMALL ALLEN WRENCH
x1



(800) 207-2587

1 Base & Arm Installation

To attach the base to the desktop, raise and rotate the base cover to expose the bolts.

Slide the base clamp around the edge of your desktop or table, and use the M1 wrench to tighten the base bolts and affix the base to the desktop.

Once the clamp is securely attached to the center of your desk, return the base cover to its proper position over the base clamp.

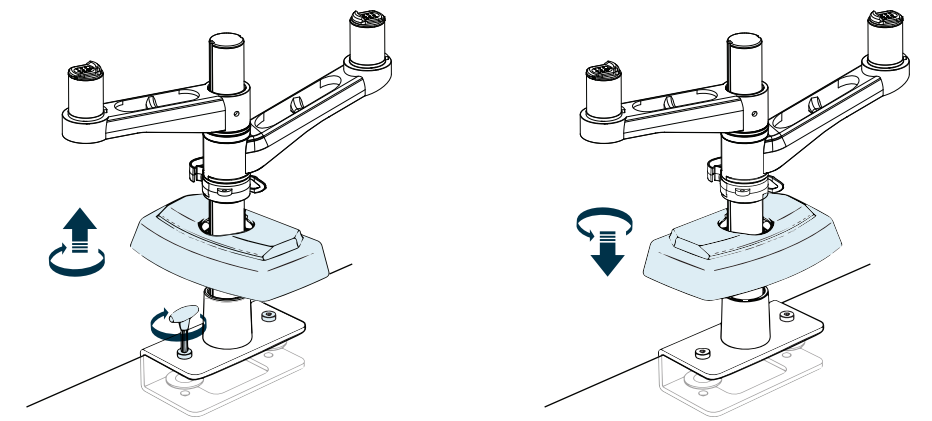

To adjust the post collar & quick release cable manager, release the clamp, move the ring to the desired height, and tighten it securely to the post using the clamp.

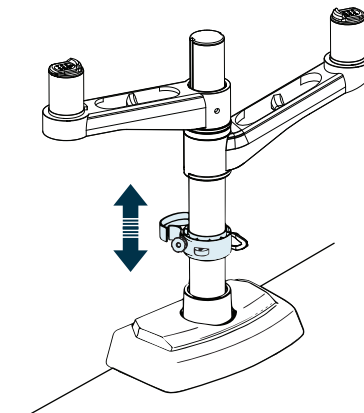

Attach swivel arms.

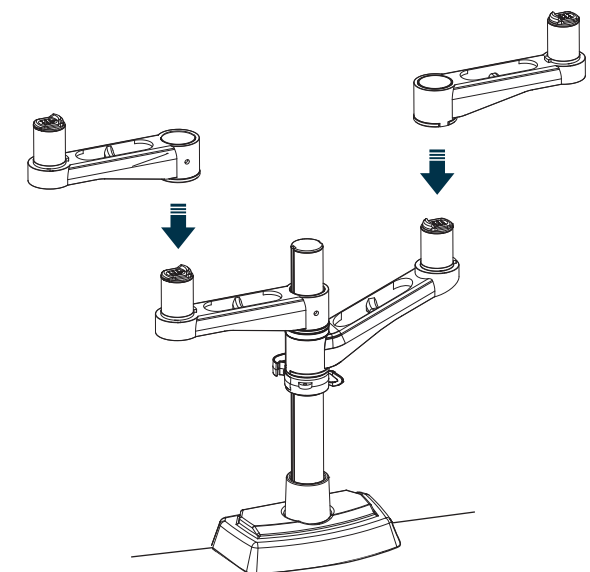

2 Monitor Installation

NOTE: Do not attempt to unfold monitor brackets before attaching them to the back of the monitors. Attach them as-is.

Affix a monitor bracket to the back of each monitor using the monitor screws provided. This can be done manually or with a flathead screwdriver.

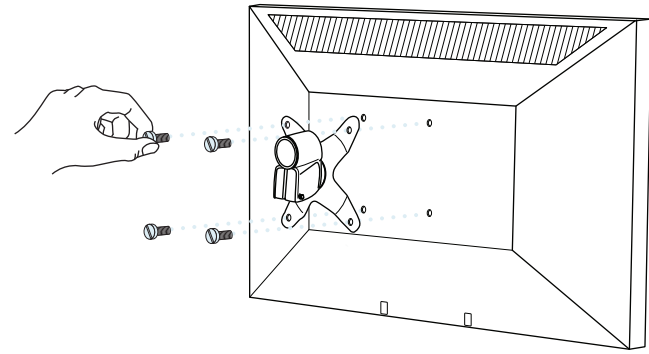

Grasp the sides of the monitor with the display screen facing up and slide the Monitor Bracket onto the top post of the Swivel Arm. Once it clicks into place, you can tilt the monitor down so the screen is facing forward. Repeat this step to mount the second monitor.

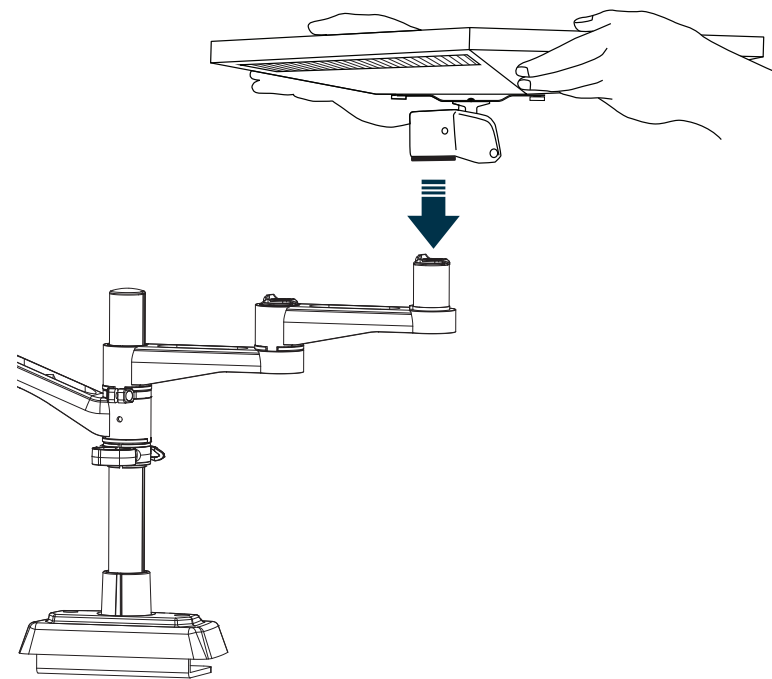

3 Monitor Arm Adjustments

CAUTION: Do not overtighten.

To tighten or loosen your monitor's swing movement, use the M3 Wrench and turn clockwise to increase the tension or counter-clockwise to decrease the tension.

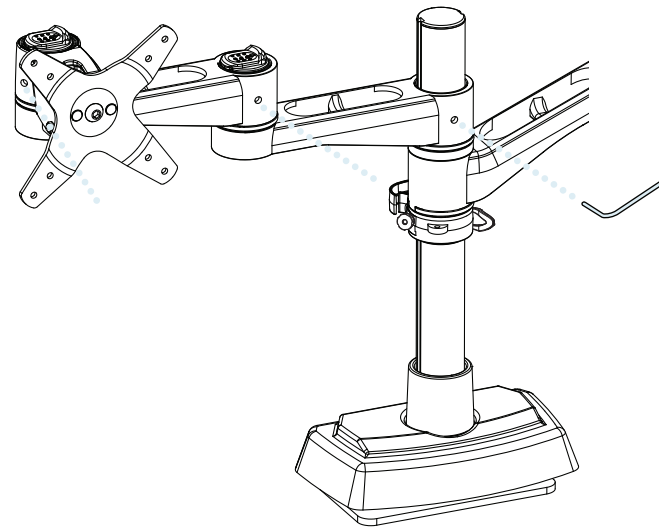

4 Route Cables

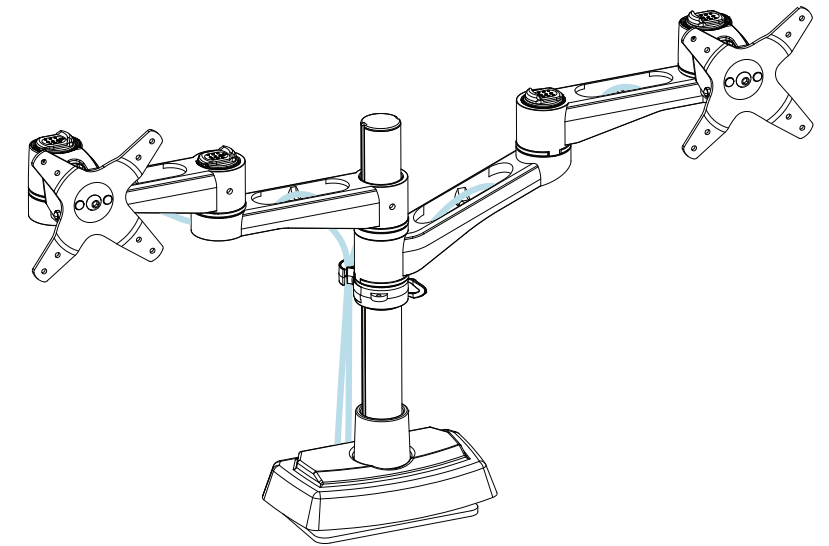

5 Features and Specifications



VESA: 75x75 / 100x100



SWIVEL: 180°



EXTENSION: 23.2 in. / 590 mm



ANGLE: 100°



PAN: 180°



VERTICAL: 13 in. / 330 mm



PIVOT: 360°



TILT: 105°



WEIGHT LOADS

PER ARM: ≤ 19.8 lb / ≤ 9 kg
POLE MAX LOAD: ≤ 44.1 lb / ≤ 20 kg